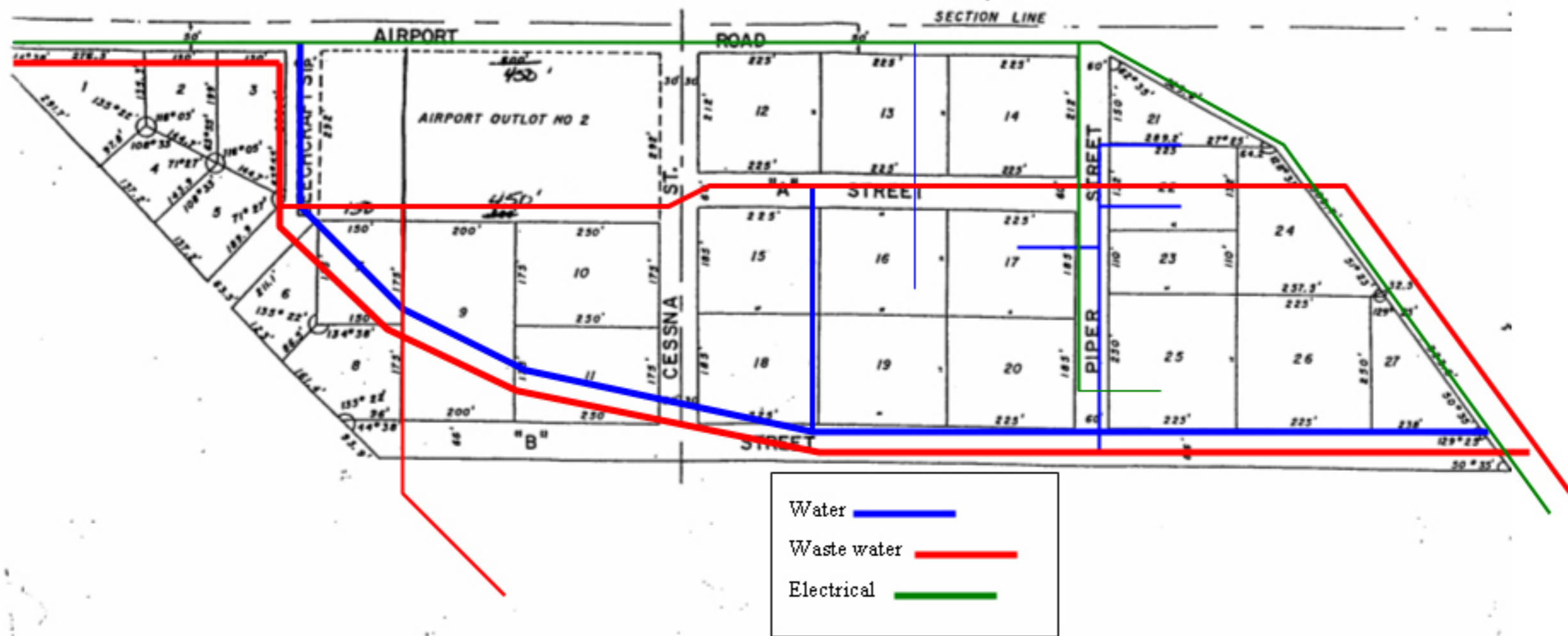

Exhibit A

N 1/2 SECTION 35; T111N, R79W
 5 TH P.M., HUGHES COUNTY, SO. DAK.

AT THIS POINT IT IS 1402.2'
 W CORNER OF SECTION 35



SCALE 1" = 200'



CERTIFICATE OF SURVEYOR

I, RAYMOND F. BIRNEM, do hereby certify that at the direction of THE CITY OF PIERRE, I have surveyed the tract of land shown on the above plat and that said tract shall be known as airport outlet number 3 located in the North Half (N 1/2), Section Thirty-five (35), Township One Hundred Eleven (111) North, Range Seventy-nine (79) West, Hughes County, South Dakota.